

Note:

After conclusion of work, bleed brakes. vehicles without ABS,

refer to 34 00 046

Vehicle with ABS,

refer to 34 00 047

Remove brake master cylinder,

refer to 34 31 500

Remove ABS hydraulic control unit,

refer to 34 51 520

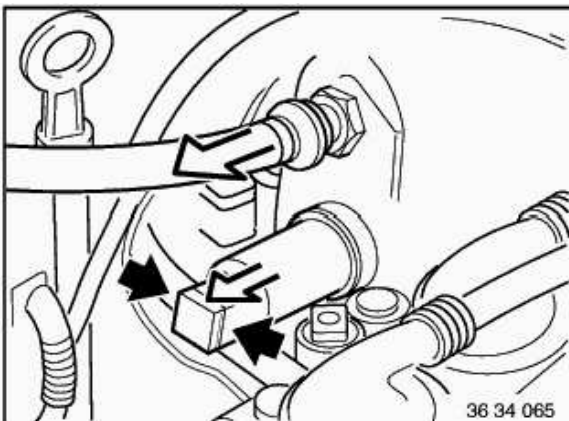

Pull off distance-sensor connector.

Pull vacuum hose off brake booster.

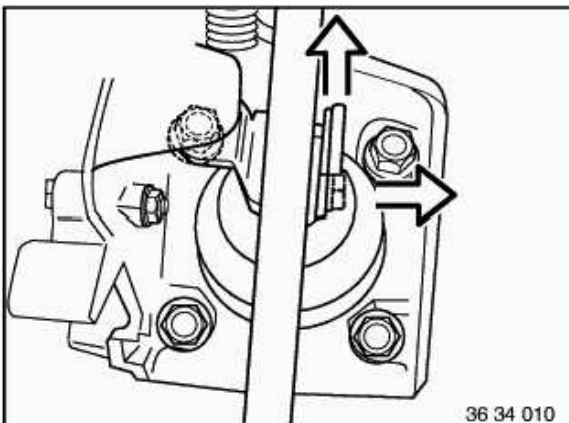

Remove panelling for instrument panel at bottom left,

refer to Gr. 51

Remove retainer/pin on swivel joint of operating rod.

Installation:

Adjust brake-light switch,

refer to Gr. 61

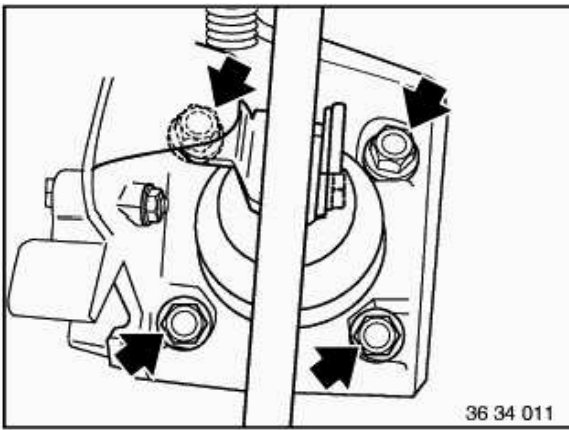

Unscrew nuts and remove brake booster

Installation:

Replace lock nuts.

For tightening torque,
refer to Technical Data.